

WONDFO BIOTECH  
**WeAreWorkingForYour Health**

# IMMUNOHISTOCHEMISTRY PRODUCT CATALOGUE

Fully-automated Immunohistochemistry Staining Instrument  
Primary Antibody  
Secondary Antibody



# Fully-automated Immunohistochemistry Staining Instrument

Efficient, flexible and stable pathological staining platform.

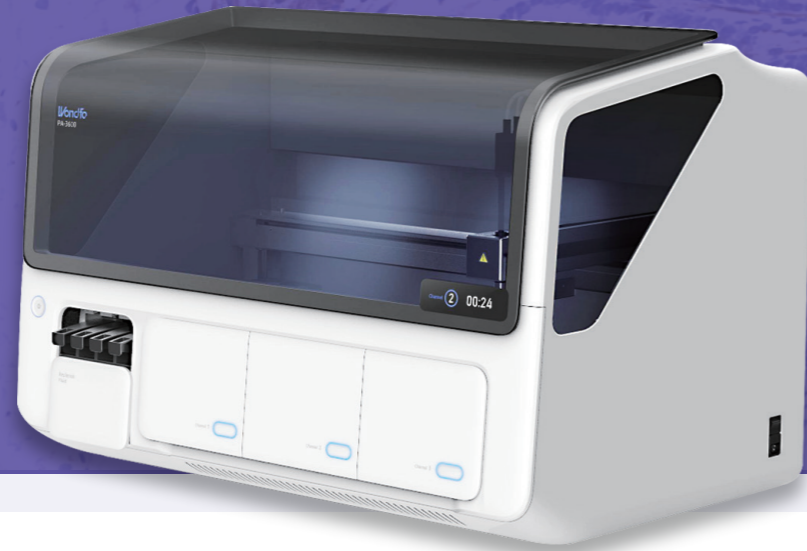

## INSTRUMENT STRUCTURE

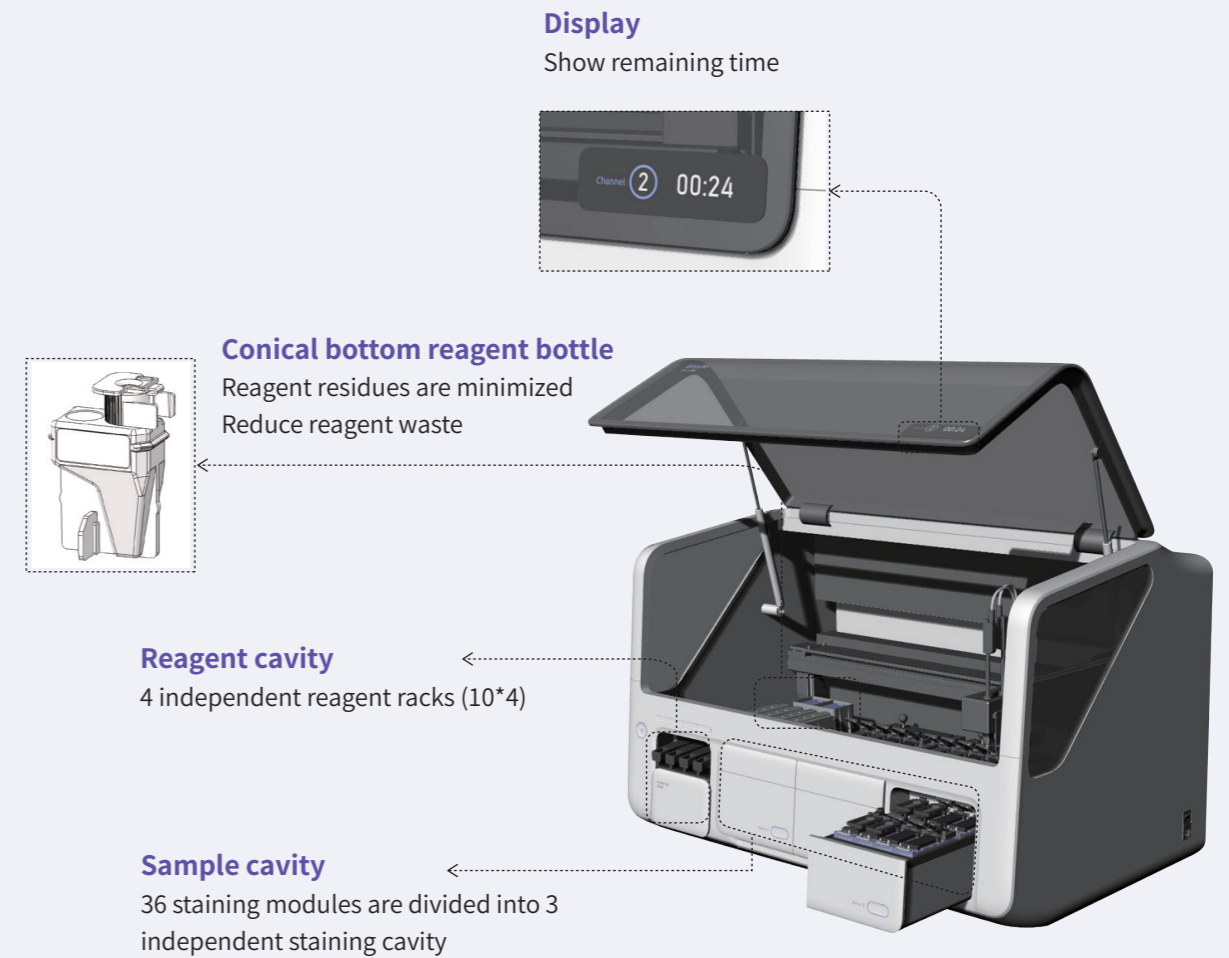

### Uninterrupted Operation

During operation, slides can be loaded continuously without interfering with existing staining procedure.



### Liquid Monitoring

Buffer real-time monitoring of the remaining liquid volume, reminding the user to add buffer and dispose of waste liquid in time.



### Run Offline

The staining program continues to run when the device is disconnected from the software.



### Parallel Expansion

One computer can control 5 instruments, saving space.

## WORK PROCESS



# KEY TECHNOLOGY

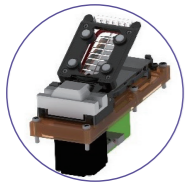

## Independent temperature control technology for each slide

- 36 staining modules are equipped with independent heating modules.
- Temperature control range from room temperature to 101°C, accurate and uniform temperature control, temperature fluctuation <0.5°C.

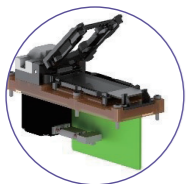

## Wave-like mixing technology

- The liquid on the surface of the slide moves in waves to improve the antigen-antibody reaction, shorten the staining time, and ensure thorough cleaning.
- The motor drives the cover plate through the worm gear, and the cover plate can be opened to a larger angle, which is convenient for maintenance and cleaning.

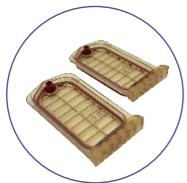

## Independent liquid cover film technology

- works long with IHC staining
- Improve reaction efficiency and ensure staining quality



## RFID chip technology

- Reduce the pre-treatment time of the experiment, and place the reagent bottle without restriction.
- 40 reagent bottles are equipped with independent scanning antennas, and the time to identify 40 reagent bottles is less than 10s. It is recognized when inserted, efficient and accurate.



## QR code identification technology

- Using QR code technology to identify slides, slides can be placed at will
- Identify 36 slides <30s

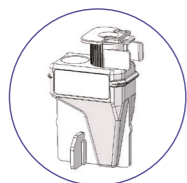

## Economical reagent design

- Only needs 130 μL to cover the whole slide
- Reduce reagent residue



## Uninterrupted operation

- During operation, slides can be loaded continuously without interfering with existing staining procedure.
- In the same way as stain module.

## Software Operation Interface

Clear Partition & High Visualization

Easy Operation

Situation Display & Reminding Timely

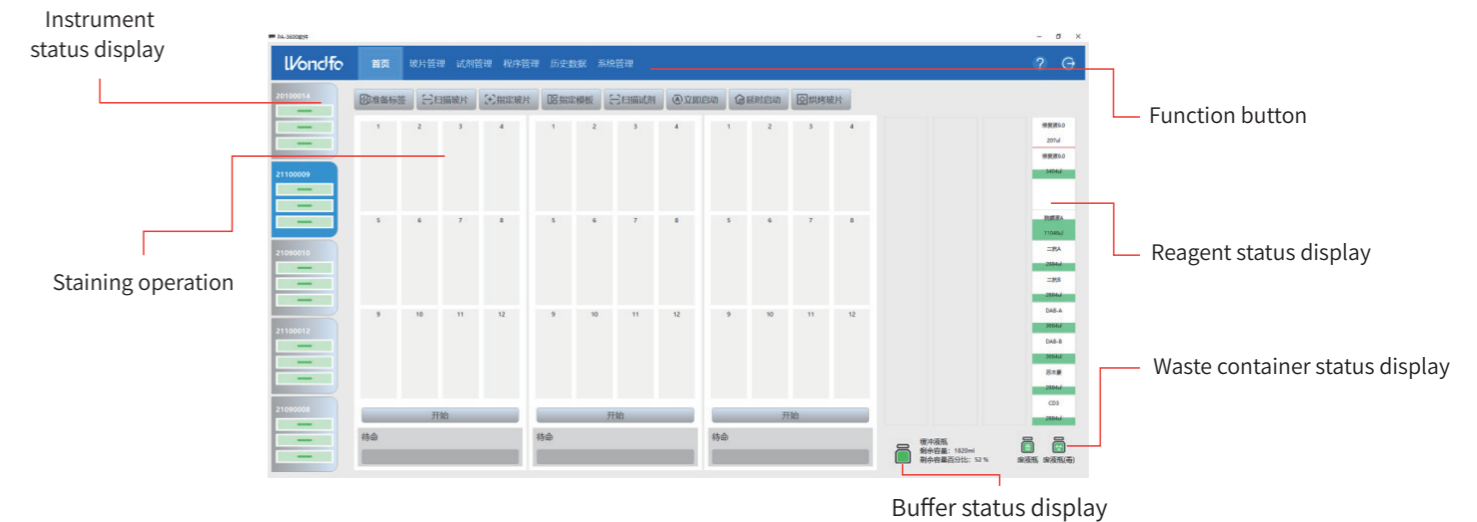

## Secondary Antibody Reagent System

- Chromogenic reagent
- Sample release reagent
- TBS-T buffer
- Antigen retrieval buffer (PH6.0)
- Antigen retrieval buffer (PH9.0)

## Technical Parameter

Item	Parameter
Instrument model	PA-3600
Appearance	Desktop
Function	Fully automated baking, dewaxing, antigen repair, staining and re-staining process.
Scope of application	IHC, ISH, CISH, FISH, Dual ICC
Slide capacity	36
Reagent capacity	40
Running time / round	< 3.5h
Temperature range	Room temperature - 101°C
Continuous loading	√
Reagent volume	≤ 130μL

Item	Parameter
Reaction kinetics	Wave-like mixing technology
Delayed operation function	√
Separate waste liquid treatment	√
Waste liquid volume	< 2L/round
Weight	135 kg
Size	1050*690*736 mm
Ambient temperature	18°C~30 °C
Rated voltage	AC220V
Input power	900 VA
Frequency	50 Hz

# MENU OF IMMUNOHISTOCHEMISTRY STAINING SYSTEM

## Head and Neck Cancer

Type of Cancer	Primary Antibody
Nasopharyngeal Carcinoma	CKpan
	CK5/6
	P63
	LCA
	Ki-67
Nasopharyngeal Angiofibroma	P53
	CD31
	CD34
	β-Catenin
	AR
	SMA
	Ki-67

Type of Cancer	Primary Antibody
Sinonasal Adenocarcinoma (Intestinal Type)	CK7
	CK20
	CEA
	CDX2
	Ki-67
Neck Tumor	Syn
	CgA
	S-100
	CK
	TTF-1
Craniopharyngioma	HMB45
	RCC
	CK
	GFAP
	Ki-67

## Respiratory System

Type of Cancer	Primary Antibody
Lung Glandular/Squamous Carcinoma	34βE12
	ALK
	CEA
	CK
	CK5/6
	CK
	Ki-67
	Napsin A
	P40
	SP-B
	TTF-1
	CD56
	CgA
	CK

Type of Cancer	Primary Antibody	
Neuroendocrine Carcinoma of the Lung	CK7	
	Ki-67	
	LCA	
	Napsin A	
	P40	
	Syn	
	TTF-1	
	Vimentin	
	CAM5.2	
	CgA	
	CK	
	Pulmonary Sclerosing Alveolar Cell Tumor	CK5/6
		CK7
		Ki-67
		P63
S100		
Syn		
TTF-1		
Vimentin		

## Digestive System

Type of Cancer	Primary Antibody
Colorectal Cancer	BRAF
	CDX2
	CK20
	CK7
	EGFR
	MLH1
	MSH2
	MSH6
	MUC2
	MUC5AC
	PMS2
	SATB2
	Villin
	β-Catenin
	Bcl-2
Colorectal Intraepithelial Neoplasia	E-Cadherin
	Ki-67
	P53
	34βE12
	CD56
Lowly Differentiated or Undifferentiated Carcinoma of the Digestive tract	CEA
	CK
	CK5/6
	HMB45
	Ki-67
	Melan-A
	P40
	P63
	S100
	Syn
	AFP
	Arginase-1
	CD34
	CK18
	CK19
CK20	
Hepatobiliary Tumor	CK7
	CK8
	Glypican-3
	GS
	HBsAg
	MUC1
	P53
	S100P
	Villin
	β-Catenin

Type of Cancer	Primary Antibody
Esophageal Cancer	34βE12
	Actin
	Calretinin
	CAM5.2
	CD5
	CD56
	CDX2
	CEA
	CK14
	CK19
	CK20
	CK5/6
	CK7
	Ki-67
	P40
Esophageal Squamous Intraepithelial Neoplasia	P53
	P63
	S100
	Villin
	CEA
	CK19
	Ki-67
	P40
	P40
	P53
P63	
Barrett's Esophagus	Bcl-2
	CDX2
	CK20
	CK7
	Ki-67
S100	

## Digestive System

Type of Cancer	Primary Antibody
Gastric Squamous Carcinoma	34βE12
	CD10
	CD56
	CDX2
	CEA
	CK
	CK19
	CK20
	CK5/6
	CK7
	CK8/18
	D2-40
	EGFR
	MLH1
	MSH2
	MSH6
	MUC1
	MUC2
MUC5AC	
MUC6	
P40	
P63	
PMS2	
S100	
Villin	
Gastroblastoma	CAM5.2
	CD10
	CD34
	CD56
	CK
	Desmin
	Ki-67
S100	
SMA	
Hypo-differentiated or Undifferentiated Gastric Cancer	CAM5.2
	CK
Intraepithelial Neoplasia	Vimentin
	CD10
	CDX2
	Ki-67
	MUC2
P53	

Type of Cancer	Primary Antibody
Small Bowel Cancer	CK7
	CK20
	CDX2
	MUC1
	MUC2
	MUC5AC
Mucinous Tumor of the Appendix	CK7
	Villin
	CK20
	MUC2
	MUC5AC
Gastrointestinal Stromal Tumor (Diagnosis and Differential Diagnosis)	CDX2
	DOG1
	CD34
	SDHB
	Ki-67
	CK
	Nestin
	Desmin
	SMA
	S-100
	CK
Gastric Inflammatory Myofibroblastic Tumor	CD34
	CD68
	DOG1
	Desmin
	S-100
	SMA
	CD10
Liver Cancer (Diagnosis)	β-Catenin
	Ki-67
	Arg-1
	AFP
	CK18
	CK19
	CD34
Pancreatic Cancer (Classified Diagnosis)	S-100P
	Ki-67
	CK19
	CEA
	MUC1
	CD56
	β-Catenin
	CD99
	CD10
	E-Cad
Ki-67	

## Urinary System

Type of Cancer	Primary Antibody
Urothelial Dysplasia/ Carcinoma in situ	Bcl-2
	CD44
	CK20
	Ki-67
	P53
Urothelial Carcinoma (Diagnosis and Differentiation)	GATA3
	P63
	CK7
	CK20
	CD44
	β-Catenin
	P53
	Ki-67
	34βE12
	34βE12
Urothelial Carcinoma	CD138
	CD44
	CDX2
	CK20
	CK7
	GATA-3
	HCG
	Ki-67
	P53
	P63
Bladder Adenocarcinoma	β-Catenin
	34βE12
	CDX2
	CK20
	CK7
	GATA-3
	Ki-67
P63	
Classification of Renal Tubular, Collecting Duct, and Urothelial Neoplasms	PAX-8
	PSA
	β-Catenin
	CD10
	PAX8
	CK7
	AMACR
	HMB45
	Melan A
	CK5/6
P63	
Vim	
Ki-67	

Type of Cancer	Primary Antibody
Clear Cell Carcinoma of the Kidney (Diagnosis and Differential)	CK7
	AMACR
	HBM45
Papillary Renal Cell Carcinoma (Diagnosis and Differential)	CD10
	CK7
	CAIX
	MACR
MiT Family Translocation Renal Cell Carcinoma	HMB45
	CD10
	CK7
	CAIX
	AMACR
Diagnosis and Differentiation of Collecting Duct Carcinoma	HMB45
	CD10
	PAX8
	AMACR
	CK5/6
Renal Angiomyolipoma	P63
	CK7
	CK
	Vimentin
	CD34
	S-100
	HMB45
Melan A	
Bladder Cancer (Diagnosis and Differential)	SMA
	Ki-67
	PAX8
	CD10
	GATA3
	P63
	34βE12
CK7	
CK20	
β-Catenin	
PAX8	
PSA	
Ki-67	

## Female Reproductive System and Breast

Type of Cancer	Primary Antibody
Epithelial Ovarian Tumor	CDX2
	CK
	CK20
	CK7
	Napsin A
	P53
	PAX-8
	Vimentin
Ovarian Germ Cell Tumor	AFP
	CD30
	CK
	D2-40
	Glypican-3
	HCG
	OCT-4
Vulvar, Vaginal and Cervical Intraepithelial Neoplasia	PLAP
	Ki-67
Cervical Glandular Epithelial Lesions	P16
	Bcl-2
	CEA
Cervical Adenocarcinoma/ Endometrial Cancer	Ki-67
	P16
	CEA
	MUC1
	Vimentin
Endometrioid Adenocarcinoma	P16
	34 $\beta$ E12
	CEA
	CK20
	CK7
	P53
	Vimentin
Uterine Leiomyoma/ Uterine Leiomyosarcoma	$\beta$ -Catenin
	Bcl-2
	Ki-67
	P16
Benign and Malignant Epithelial Tumors of the Breast	P53
	Calponin
	CK5/6
	CK8/18
	E-Cadherin
	Ki-67
	P120

Type of Cancer	Primary Antibody
Intraductal Papillary Lesions	Calponin
	CK14
	CK5/6
	CK8
	CK8/18
	Ki-67
Microinvasive Carcinoma of the Breast	P63
	Calponin
	CK
	CK5/6
Invasive Ductal Carcinoma of the Breast with Lobular Carcinoma	P63
	34 $\beta$ E12
	E-Cadherin
	Ki-67
	P120
Basal-like Breast Cancer	CK19
	CK5/6
	EGFR
	Ki-67
	P53
Secretory Carcinoma of the Breast	P63
	CK5/6
	E-Cadherin
	EGFR
	Ki-67
	P63
Paget's Disease of the Breast	S100
	CEA
	CK5/6
	CK7
	EGFR
	GCDFP-15
	Ki-67
Adenoid Cystic Carcinoma of the Breast	S100
	34 $\beta$ E12
	CK
	CK7
	CK8/18
	E-Cadherin
	GATA-3
	Mammaglobin
	P63
	S100
SMA	

Type of Cancer	Primary Antibody
Primary/Metastatic Breast Cancer	CK20
	CK7
	GATA-3
	GCDFP-15
	Mammaglobin
	TTF-1
	Villin
Trophoblast Markers	CKpan
	CD10
	CK18
	P63
	hPL
	Ki-67

Type of Cancer	Primary Antibody
Yolk Sac Tumor	D2-40
	AFP
	CK
	4-Oct
	SALL-4
	PLAP

## Male Reproductive System

Type of Cancer	Primary Antibody
Prostate Cancer (Differentiation of benign and malignant)	34 $\beta$ E12
	P63
	AMACR
Intraductal Carcinoma of the Prostate (Diagnosis and Differential)	P63
	AMACR
	34 $\beta$ E12
	Ki-67
	ERG
	TTF-1
	AR
Neuroendocrine Tumors of the Prostate	CK5/6
	ERG
	Ki-67
	P40
	PSA
	PSAP
	PSMA
	34 $\beta$ E12
	P63
	AMACR

Type of Cancer	Primary Antibody
Testicular Tumor (Classification and Differentiation)	D2-40
	PLAP
	45203
	CD30
	Glypican3
	AFP
	HCG
	Ki-67
hPL	

## Endocrine System

Type of Cancer	Primary Antibody
Papillary Thyroid Carcinoma	BARF
	CD56
	CK19
	Galectin-3
	Ki-67
	TPO
Follicular Thyroid Carcinoma	TTF-1
	CK
	CK19
	E-Cadherin
	Galectin-3
	Ki-67
	P53
	TPO
Medullary Thyroid Carcinoma	TTF-1
	β-Catenin
	Calcitonin
	CD56
	CEA
	CK
	Ki-67
	TTF-1
	Vimentin

## Skin Tumor

Type of Cancer	Primary Antibody
Skin Tumor (classification and identification)	CKpan
	Ki-67
	CK7
	P63
	CK5/6
Benign and Malignant Melanocytes (Identification)	HMB45
	MelanA
	Tyrosinase
	Bcl-2
	P53
	Ki-67

Type of Cancer	Primary Antibody
Parathyroid Tumor	Calcitonin
	CK19
	CK8/18
	Ki-67
	PAX-8
	PTH
	TTF-1
Neuroendocrine Tumor	NSE
	PGP9.5
	CD56
	NSE
	PGP9.5
	CD56
Pituitary Adenoma	PRL
	Ki-67
	MelanA
Adrenal Tumor	Calretini
	NSE
	S-100
	CK
	Vimentin
	CEA
	Ki-67

Type of Cancer	Primary Antibody
Malignant Melanoma (Diagnosis and Differential)	CK
	Vim
	S-100
	HMB45
	MelanA
	P53
	Ki-67

## Lymphatic System

Type of Cancer	Primary Antibody
B-cell Lymphoma	Bcl-2
	Bcl-6
	CD138
	CD23
	CD3
	CD43
	CD5
	CD79α
	Cyclin D1
	TdT
B-cell Lymphoma with Nodular Architecture	Bcl-2
	Bcl-6
	CD10
	CD19
	CD21
	CD22
	CD23
	CD3
	CD43
	CD68
Diffuse Small B-cell Lymphoma	CD79α
	Cyclin D1
	Ki-67
	Bcl-2
	Bcl-6
	CD10
	CD138
	CD21
	CD23
	CD3
CD35	
CD38	
CD43	
CD5	
CD79α	
CD99	
Cyclin D1	
Kappa	
Ki-67	
Lambda	

Type of Cancer	Primary Antibody
Diffuse Large B-cell Lymphoma	ALK
	Bcl-6
	CD10
	CD15
	CD21
	CD3
	CD30
	CD38
	CD43
	CD5
	CD79α
	Cyclin D1
	EMA
	GrB
	Ki-67
MUM1	
T-cel Lymphoma	PAX-5
	ALK
	Bcl-6
	CD10
	CD2
	CD25
	CD3
	CD4
	CD4
	CD43
	CD45RO
	CD5
	CD56
	CD7
	CD79α
CD8	
GrB	
Ki-67	
TdT	
TIA-1	

## Lymphatic System

Type of Cancer	Primary Antibody
Hodgkin Lymphoma	Bob.1
	CD15
	CD21
	CD23
	CD3
	CD30
	CD45RO
	CD79α
	CK
	EMA
	Ki-67
	LCA
	MUM1
	PAX-5
	Precursor Lymphoid Tumor
CD13	
CD19	
CD1α	
CD2	
CD22	
CD3	
CD34	
CD38	
CD43	
CD5	
CD56	
CD7	
CD79α	
CD99	
Mantle Cell Lymphoma	Ki-67
	Bcl-2
	TdT
	CD3
	CD5
	CD79a
	Cyclin-D1
	CD10
	CD21

Type of Cancer	Primary Antibody	
Bone Marrow Lesion	AAT	
	AAT	
	CD13	
	CD138	
	CD15	
	CD163	
	CD19	
	CD2	
	CD25	
	CD3	
	CD34	
	CD38	
	CD4	
	CD43	
	CD45RO	
	CD5	
	CD56	
	CD61	
	CD68	
	CD7	
	CD79α	
	CD8	
	Cyclin D1	
	GrB	
	Kappa	
	Lambda	
	Lysozyme	
	MUM1	
	PAX-5	
	TdT	
	TIA-1	
	T/NKT Cell Lymphoma	CD3
		CD45RO
		CD79a
		CD56
TIA-1		
Burkitt Lymphoma	CD3	
	CD79a	
	CD10	
	Bcl-2	
	Bcl-6	
	Ki-67	
	TdT	
CD21		

Type of Cancer	Primary Antibody
Lipofuscinosis-like T-cell Lymphoma	CD3
	CD7
	CD43
	TIA-1

## Bone and Soft Tissue

Type of Cancer	Primary Antibody
Synovial Sarcoma	CK
	BCL-2
	CD99
	SMA
	CD34
Epithelioid Sarcoma	Desmin
	CK
	Vimentin
Neurofibroma	CD34
	Vimentin
	S100
	CD34
Schwannoma	MBP
	S100
	GFAP
	SMA
Chondrosarcoma	S-100
	Vimentin
	CK
	CEA
	SMA
Angiosarcoma	Desmin
	NSE
	CD34
	CD31
	ERG
FLI1	
D2-40	

Type of Cancer	Primary Antibody
Lipofuscinosis-like T-cell Lymphoma	CD3
	CD79a
	CD10
	Bcl-2
	Bcl-6
	Ki-67
CD21	

Type of Cancer	Primary Antibody
Lymphangioma	D2-40
	CD31
	CD34
Rhabdomyosarcoma	MyoDI
	Myoglobin
	Desmin
Leiomyosarcoma	SMA
	Desmin
	h-Caldesmon
	P16
	P53
PNET, Ewing sarcoma, Olfactory Blastoma, Medulloblastoma	Ki-67
	CD99
	S-100
	CD56
	GFAP
Notochord, Parachordoma	Vimentin
	ERG
	SMA
	S-100
	CK
Chondroblastoma	GFAP
	CD68
	CD99
	S-100
	CK
Vimentin	



## ORDER INFORMATION

### Nervous System Tumor

Type of Cancer	Primary Antibody
Classification of Central Nervous System Tumor	Olig2
	S100
	CK
	Vimentin
	ATRX
	BRAF(VEI)
	p53
Pituitary Adenoma	Ki-67
	PRL
Glioma	P53
	ATRX
	GFAP
	Vimentin
	S-100
	P53

Type of Cancer	Primary Antibody
Malignant Peripheral Nerve Sheath Tumor	S-100
	SOX-10
	CK
	Desmin
	SMA
	MyoD1
Meningioma	GFAP
	Vimentin
	S-100
Nerve Fiber/Schwannomas	SSTR-2
	GFAP
	Vimentin
	S-100
	CK
Central Neurocytoma	SOX10
	GFAP
	S-100
	Calretinin

Catalog No.	Primary Antibody
WB05	Actin
WD47	Arginase1
WB10	ATRX
WB13	bcl-2
WB14	bcl-6
WB16	Beta-catenin
WB26	CAIX9
WB28	Caldesmon
WB29	Calponin
WB30	Calretinin
WB32	CD10
WB33	CD123
WB34	CD138
WB38	CD163
WB39	CD16
WB41	CD1a
WB42	CD21
WB44	CD23
WB47	CD2
WB48	CD30
WB50	CD34
WB51	CD35
WB52	CD38
WB53	CD3
WB57	CD45R
WB58	CD45
WB59	CD4
WB60	CD56
WB62	CD5
WB63	CD61
WB65	CD68
WB66	CD71
WB68	CD79a
WB69	CD7
WB70	CD8
WB72	CDX-2
WB73	CEA
WB74	Chromogranin
WB75	C-MET
WB80	Desmin
WB81	DOG1
WB82	E-Cadherin
WB85	Ep-CAM
WD50	ERG
WB89	EZH2
WB97	Galectin-3

Catalog No.	Primary Antibody
WB98	Gastrin
WC01	GCDFP-15
WC03	GLUT-1
WC06	Glypican 3
WC11	HLA-DR
WC12	HMB-45
WC20	IgG4
WC24	Inhibin, alpha
WC25	Insulin
WC27	Ki-67
WC31	Langerin
WC32	LEF-1
WC38	Mammaglobin
WC39	MART-1/melan A
WC40	MCT
WC43	MLH1
WC46	MSH2
WC47	MSH6
WC48	MUC-1
WC49	MUC2
WC50	MUC5AC
WC51	MUC6
WC52	MUM1
WC56	Myoglobin
WC57	Napsin A
WC63	NSE
WC67	Oligo-2
WC68	p120
WC69	p16
WC72	p40
WC73	p53
WC74	p57
WC75	p63
WC77	Pax5
WC78	Pax-8
WC80	PLAP
WC81	PMS2
WC85	pS2
WC86	PSAP
WC87	PSA
WC88	PSMA
WC91	Rb Gene Protein
WC94	S100P
WC95	S100
WD53	SATB2
WC97	SDHB

Catalog No.	Primary Antibody
WC99	SMA
WD01	Smm
WD02	Somatostatin
WD06	Synaptophysin
WD93	TACSTD2
WD13	TIA-1
WD15	TOP2A
WD16	TPO
WD17	Tyrosinase
WD20	Villin
WD21	Vimentin
WD22	WT1
WD23	ZAP-70
WD24	$\beta$ -tubulin-III
WD26	TTF-1
WD27	GFAP
WD91	TRK
WD31	CK pan
WD33	CK14
WD34	CK17
WD35	CK18
WD36	CK19
WD37	CK20
WD38	CK5&6
WD59	CK5
WD39	CK7
WD41	CK8
WD42	CAM5.2
WD43	CK34 $\beta$ E-HWM
WD92	Cellular tight junction proteins 18.2
WD94	Folate receptor $\alpha$
WC15	Human Growth Hormone
WC53	Myelin Basic Protein
WB07	AFP
WB08	AMACR/p504s
WD60	AR
WB15	Ber-EP4
WD49	BOB1
WB18	BRAF
WB23	C4d
WB27	Calcitonin
WB31	CD105
WB40	CD19
WB43	CD22
WB49	CD31
WB55	CD44

Catalog No.	Primary Antibody
WB71	CD99
WD30	CK-HWM
WB79	D2-40
WB83	EGFR
WB90	Factor VIII
WB91	Fascin
WB93	FLI1
WB99	GATA3
WC02	Glucagon
WC07	Granzyme B
WC04	GS
WD61	HBsAg
WC14	HCG
WC09	Hepatocyte
WC16	HPL
WC19	IgD
WC23	IMP3
WC29	Lambda
WC34	LRP
WC36	Lysozyme
WC54	Myeloperoxidase
WC55	Myo D1
WC58	Nestin
WC59	NeuN
WC60	Neurofilament
WC64	Oct2
WC66	Oct4
WC79	PCNA
WC84	PGP9.5
WC83	PRL
WC90	PTH
WD54	SOX-10
WD04	SOX-2
-	SSTR2
WF13	STAT6
WD07	TAG-72
WD08	TdT
WD12	THY
WD52	PD-1
WD40	CK8 & 18